

12

11

10

9

8

7

6

5

4

3

2

1

Sheet top of motor pod with 1mm ply or 2mm balsa (not shown)

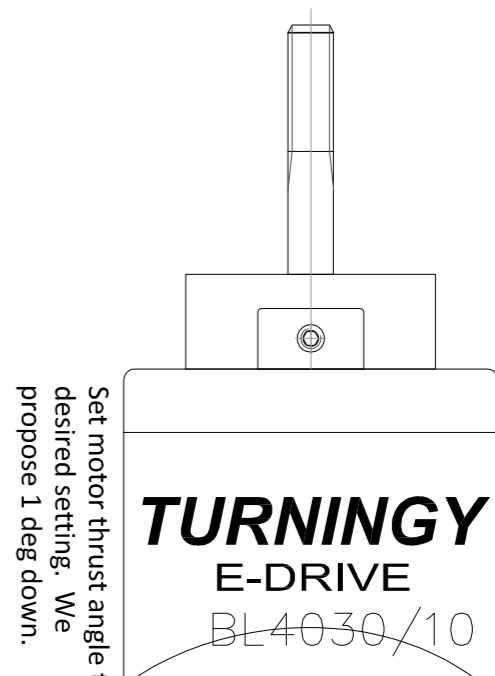
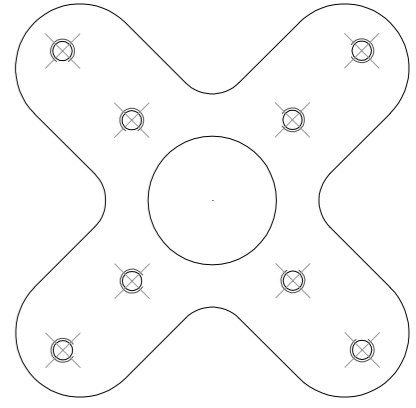

Sheet bottom of motor pod with 1mm ply or 2mm balsa. Not shown. Sheeting does not extend beyond wing leading edge.

Room for motor controller

Room for battery

M4 blind nut

Support brackets

M4 blind nut

Support brackets

F4

F5

F3

F1

F2

F3

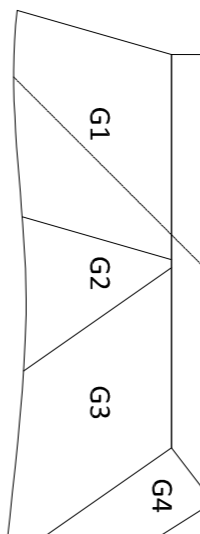

H1

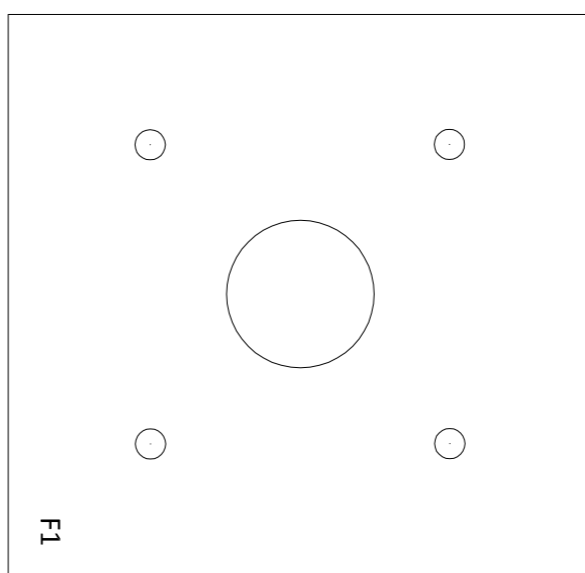

Cut 2 pcs



F2

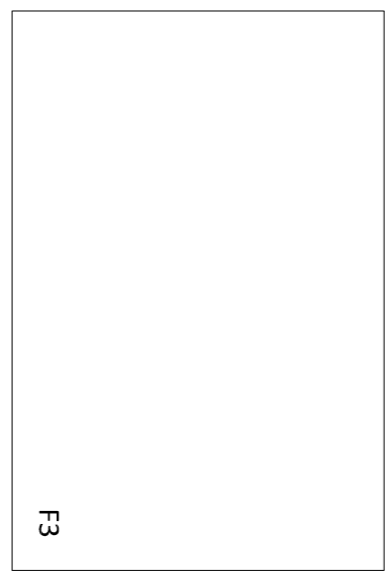

F3

Cut internal structure parts to suit your motor & battery. Drawings are just an guide.

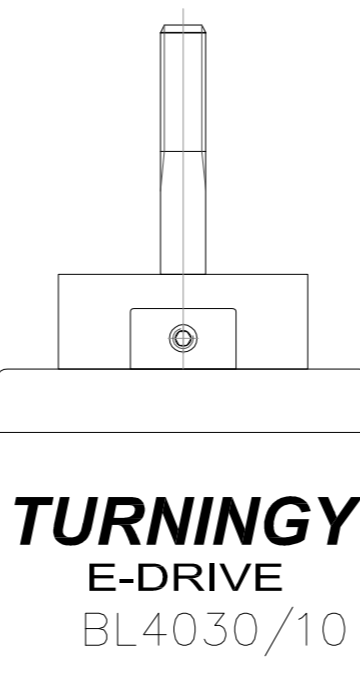

Motor drawn here is only indicative. Select motor to suit your plane & weight.

F1

F4

F2

F5

F3

IMPORTANT : add support brackets inside wing.

IMPORTANT : add support brackets inside wing.

IMPORTANT : add support brackets inside wing.

IMPORTANT : add support brackets inside wing.

This design applies to following Iwaru Oy plans:  
- 125 PIK-7 Harakka I (33%)  
- 142 PIK-7 Harakka II (33%)  
- 145 PIK-7 Harakka II (33%)  
  
The overall design idea of this plan is that motor pod would be gc-neutral, ie. it should be possible to use it with no changes to nose weight.  
  
All materials (with exception of top & bottom sheeting) 3mm iteply.  
Check & verify motor & prop clearances before commencing building.

Cut 2 pcs

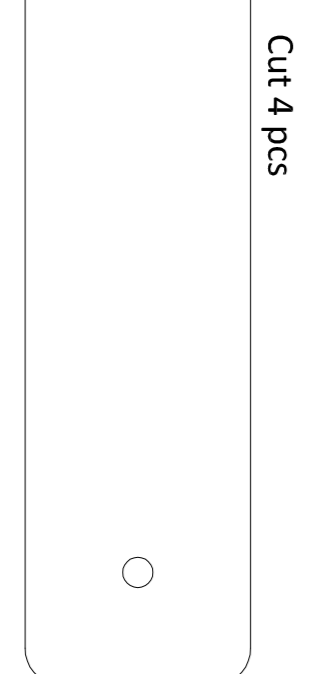

Cut 4 pcs

THIS DESIGN IS COPYRIGHT BY IWARU OY.

It has been released only for free, non-commercial use. That means that you can make copies of this plan for your personal use, make as many planes as you want and fly them any way you want. Enjoy!  
You are not allowed to start selling copies of this plan or kits based in this design and/or plan. Any commercial use, whatsoever, without Iwaru Oy's express written consent is strictly prohibited. If you want to use this design commercially pls, contact Iwaru Oy. For contact details see www.iwaru.fi, or tuotala@iwaru.fi.

This design has no warranty whatsoever. It has been released as-is, and any plane based on this design/plan is on sole responsibility of builder and the pilot of plane.

For updates see www.iwaru.fi

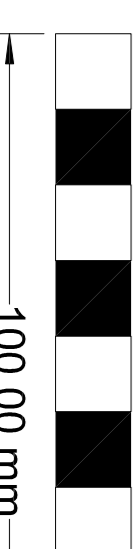

Scale

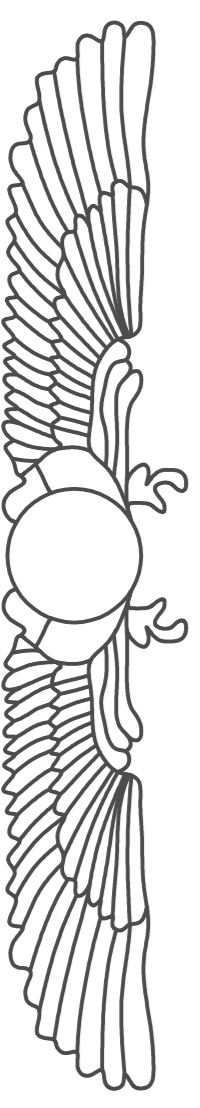

Iwaru Oy

Tuomas Otala, Iwaru Oy

PIK-7 Harakka I/II/III (33%), motor pod

TITLE	PROJECT	REV
PIK-7 Harakka I/II/III (33%), motor pod	157-01	02
SCALE	SCALE	SHEET
1:1	14.9.2013	157-01-1

12

11

10

9

8

7

6

5

4

3

2

1